



EQUIRRE REF: 389130

COMMON SPECIFICATIONS

INSTRUCTIONS OF INSTALLATION

LINE DRAWING FOR EQUIRRE REF: 389130

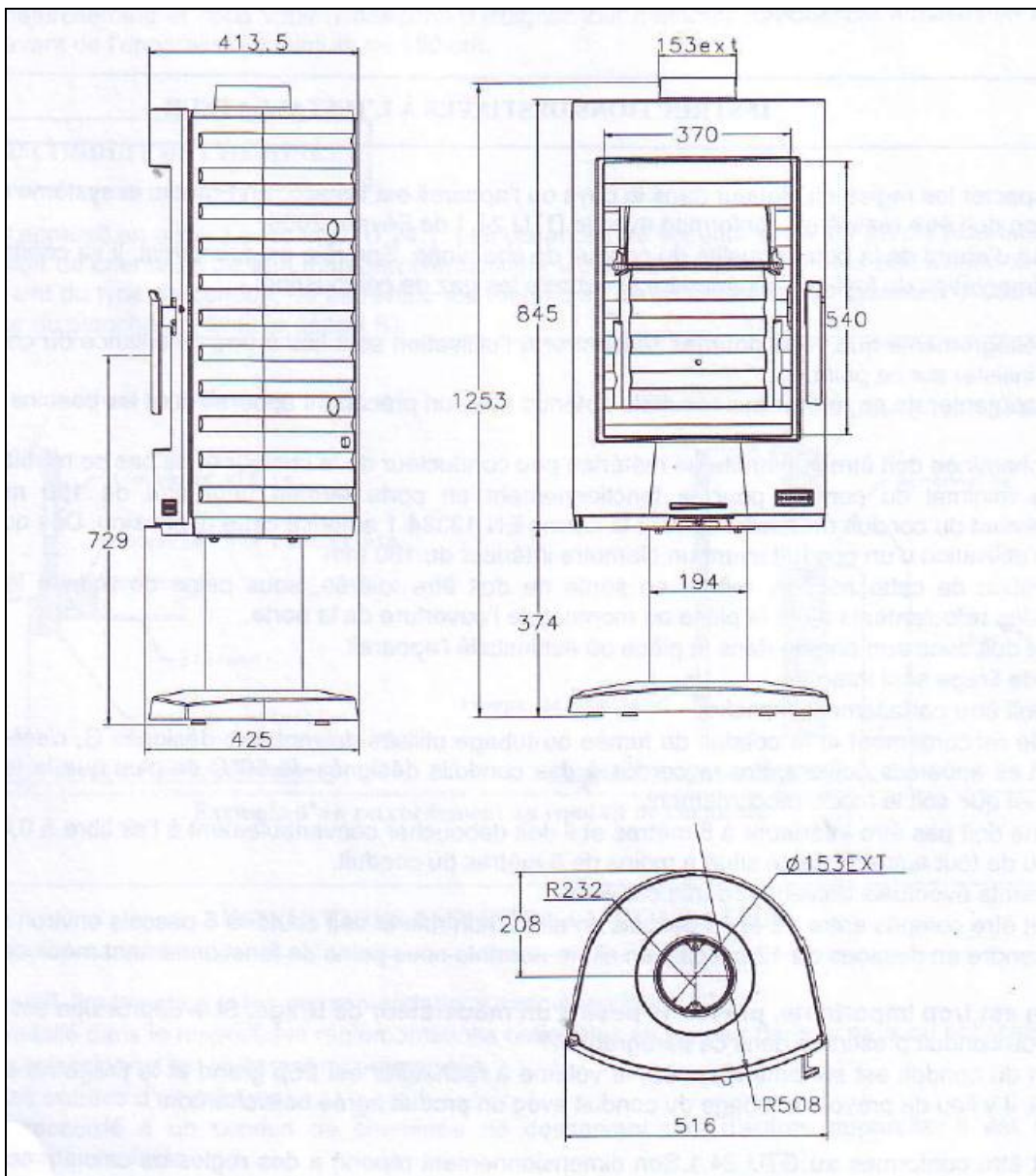

TECHNICAL CHARACTERISTICS

REF: 389130	
Dimensions (W/D/H)	516mm x 425mm x 1253mm
Diameter of Outlet	153 diameter
Fuel type	Wood
Loading from the front	Logs of 33cm
Nominal kW Output	7.5kW
Regulation	Manual
Loading	Front Loading
Heating Volume	90-240m ³
Consumption at normal rate	1.83kg per hour
Functioning time	45 minutes for 1.83kg wood at 12% humidity
Weight	138kg
Safety distances to combustible materials	30cm rear, 40cm sides, 150cm front

CHIMNEY & CONNECTION

The condition of the chimney flue is of prime importance. It will determine the final result: to ensure constant supply of primary air to the heater and extraction of the burned gasses. Most problems experienced are due to a defect of the chimney.

One should not compare or refer to the results provided by a previous model or make, which may have different needs of air.

- A good chimney must be built with materials of little heat transmission which do not cool down easily.
- The minimal section of the chimney for utilisation door closed is 2.5 dm², which corresponds to a diameter of 153mm. (Present regulations.)
- Not a single reduction of the flue, even at the top outlet is permissible, as it may cause a reduction of fume exhaust, which can provoke some down draught in the room when opening the door.
- The chimney must originate from the room where the heater is installed.
- The conduit to be perfectly sealed.
- The height must not be lower than 5 meters, with a reasonable upper clearance in fresh air of 0.40m, minimum above the pitch of the roof or from any other obstacle at a distance of less than 8 meters from the conduit.
- The draught should be between 1.5mm CE & 2mm CE during normal functioning, and dropping to 0.5mm CE on slow running.
- The draught must not come down below 1.2mm CE, in normal running mode.
- If the draught is too strong a draught moderator can be fitted. If the draught is insufficient, the characteristics prescribed in the paragraph for the chimney must be followed.
- If the cross-section of the chimney is too large, the volume to warm is too great and the draught will not operate normally. In that case, install a stainless steel flexible lining or other suitable lining in the chimney. The recommended size is not to be less than 153mm diameter (up to 180mm), for a height of up to 7 meter.
- It is recommended to fit a well-sealed cleaning trap at more or less 50cm below the heater outlet.
- Before connecting, make sure that the chimney is perfectly clean. If necessary have the chimney swept.
- The appliance to be installed must conform to the D. U. T. specifications in force. The installation to be carried out by a qualified professional installer. All local and national rules are to be respected.
- If extractors are installed in the same room or space where the heater is situated they could dangerously affect the running of the heater.
- Never block the air intake of the room and install them in a manner that they cannot be obstructed. The heater takes the air from the room, therefore it is necessary to ensure sufficient air intake from outside.
- The appliances are not made to be connected to multiple chimneys.

Figure 1

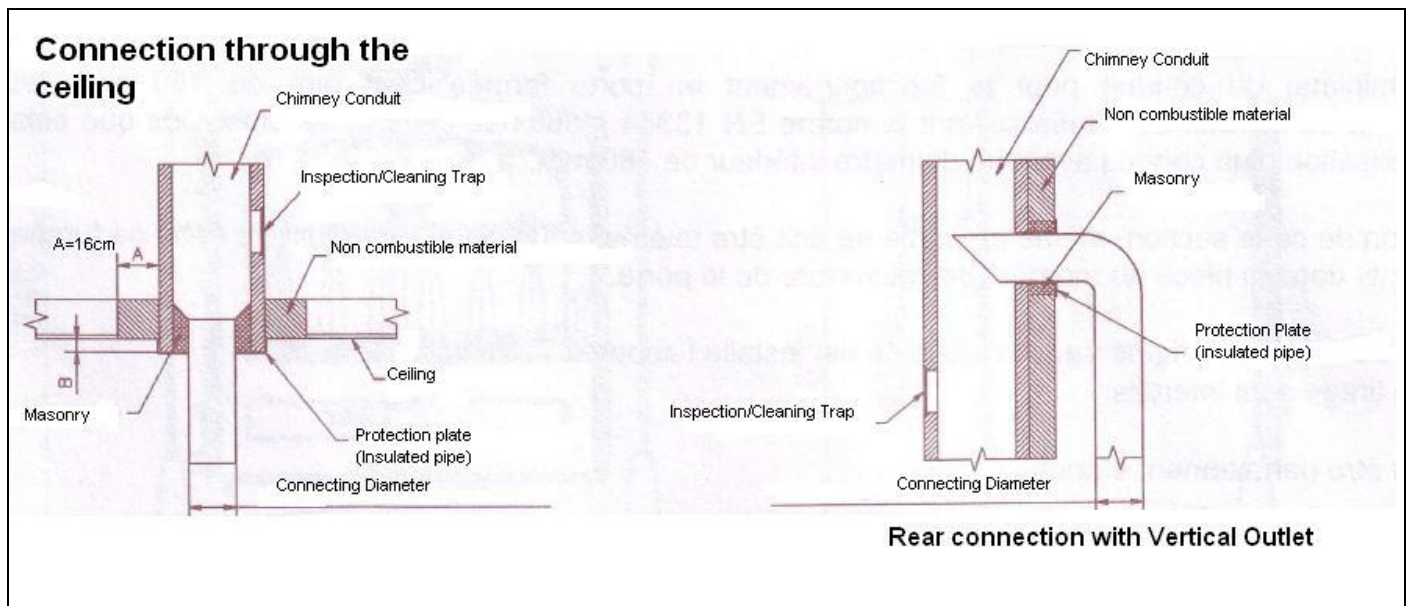

IMPORTANT

- If the floor is made of flammable materials, it is necessary to protect it with some insulation (e.g.: tiles) up to at least 40cm in front of the heater (Fig 1). Preferably use enameled flue pipes, as their resistance to corrosion is remarkable. Their length into the chimney (as long as the chimney size is correct) should be as short as possible, so that the heated fumes are, as it should be, used to make the draught.
- The back wall must not be made of flammable materials. If it is, it must be protected sufficiently and effectively insulated and a security distance of 30cm should be maintained.
- The walls on the left and right of the unit to be a distance of at least 40cm, to allow the lateral loading of 33cm logs.
- The ceiling should be at least 80cm higher than the top of the unit.
- The unit radiates naturally and all combustible material (wooden chairs, carpets) to the front of the unit, should be a minimum of 150cm away.

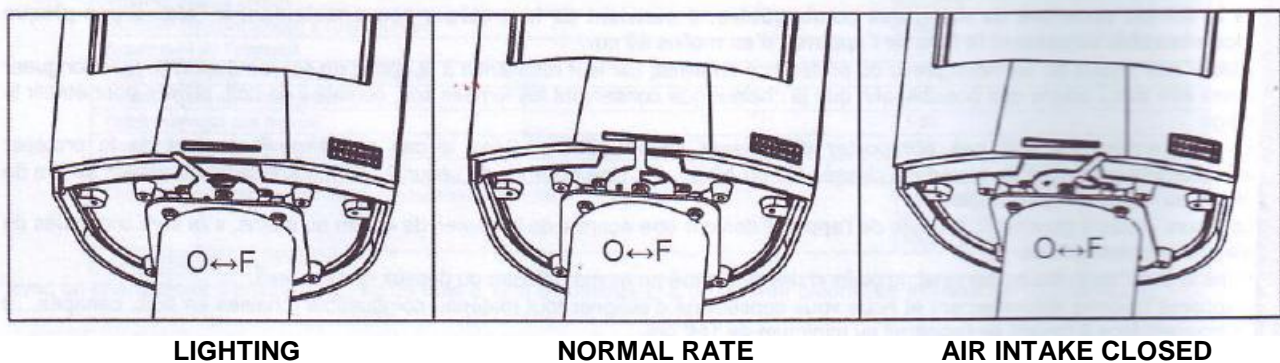

LIGHTING AND OPERATION

- Open the door
- Completely open the air control situated on the door and use a moderate amount of starter wood.
- To assist lighting, one can leave the door unlatched for a few minutes BUT ONLY IF THE UNIT IS UNDER CONSTANT SUPERVISION.
- Once the fire is burning, load the desired quantity of wood and adjust the air slide. Regulate the unit as required. Air lever to the left is fully open and to the right is fully closed.

REMARK

- During the functioning of the heater keep all material that could be altered by the heat: furniture, paper and garments, away from the heater.

ATTENTION

- While functioning normally, use the operating tool and glove for operation (the handle will be hot.)
- While the heater is burning, keep the door closed.
- The door can only be opened when lighting the unit, loading more wood or removing ash.
- The loading can be done from the front door.
- The regulation of the combustion is done by moving the slide to the open or closed position on the front door. (Closed to 2cm open - slow, 2 – 5cm open – moderate operation, >5cm open – high)
- For normal running use 3 or 4 logs with the air slide open 1/3.
- For slow running, leave the fire until it has burned quite low, then load with one or two logs and close (or almost close) the slide. It is always possible to add more logs to prolong the period of combustion of the heater.
- Do not load the firebox with a load higher than 25cm.

HOW TO USE THE UNIT

- Always follow instructions.
- During the first lighting of your heater use small loads so as to verify that the unit is functioning properly.
- Gradually increase the amount of logs used over a few days.
- Never use the heater as an incinerator.
- Use only the recommended fuel.
- Never use the unit with the door open.
- Don't use the heater if the glass is broken or cracked. Regularly check the rope seals and ensure that all clamps holding the glass in place are not too tight. The glass does expand and contract and this should not be restricted.
- Proceed with glass replacement before re-lighting.
- After a long period in which the unit has not been used, make sure that there are no obstructions in the chimney.
- When reloading the unit, one should ensure that the fire is quite low. The door should not be opened too rapidly as it may draw flames towards the door and the opening. Always open the door slowly so that the draw up the chimney is maintained and avoids smoke being expelled through the door being opened.

IMPORTANCE OF FUEL

- The GODIN heater has a thermal output of about 73.5%, therefore they should give full satisfaction. The said value corresponds to the best performances.
- Remember that any heater can only give off the amount of energy contained in the fuel used.

If you feel your unit does not heat well, then:

- Either there is insufficient burning fuel or the burning fuel does not possess sufficient energy.
- Burn only dry wood, which is +/- two years old (36 months will be even better)
- In principle, all wood has the same calorific value for the same weight.
- Hard wood will be better because it is denser and often less humid.
- The humidity contained in wood alternates from 15% for dry wood up to 50% for wet wood. You will require lots of energy to evaporate the water.
- The available calories for heating are 3600 per kilo of dry wood with 15% humidity. The calories will only be 1500 per kilo for wood with 50% humidity.
- The use of wet wood, will also create condensation in the chimney, it will cause the chimney to clog up faster and can cause chimney fires.

DE-ASHING

- Empty the ashtray at least every 2 to 3 days following the use of the heater – take care and use the glove and tool especially if the tray is hot.
- Never let the ashes pile up in the ashtray until they touch the grate. Consequently the grate will not cool down and will rapidly deteriorate.

CLEANING

- Sweep your chimney at least once a year and ensure the good condition thereof.
- When not in use, clean the interior of the unit without forgetting the air channels.
- Check the heater and make sure the door seals are in a good condition. Replace if necessary.
- Clean the glass door with GODIN Net. Ref.: 0009 or other suitable products.
- In case of chimney fire, close the air control and call the fire brigade.
- During the off season, all cast iron requires a minimum of maintenance. For this purpose it is recommended to use the GODIN graphite paste. This maintenance also applies to the internal firebox, particularly if the heater is installed in a house which is only used occasionally (Holiday house).

MAINTENANCE

- Have your heater checked once a year by qualified personnel.
- Never clean the glass while the unit is still hot.

ATTENTION

When lighting your heater for the first time, it is necessary to run the heater in using a low fire, so as to allow parts to expand normally. The handles are hot during normal functioning, use the operating tool and glove.

REPLACEMENT OF PARTS

If after many years the replacing of parts becomes necessary, call your supplier or qualified GODIN installer. Provide the model number on the plaques situated at the rear of the unit or on your guarantee card. Keep even after guarantee period has expired.

The installer will be able to supply all necessary parts and proceed with repairs,

Never use spare parts that do not originate from the GODIN factory. Never try and modify the heater without authorisation.

REPLACEMENT

We would like to remind the User, that the Manufacturer's responsibility is restricted to the product as it is produced. The installation and commissioning of the unit is the responsibility of the Installer who must follow the rules and regulations in force as outlined in the manual.

So as to constantly improve the quality of products, the GODIN Co. reserves the right to modify their appliances without notice.

CORPS

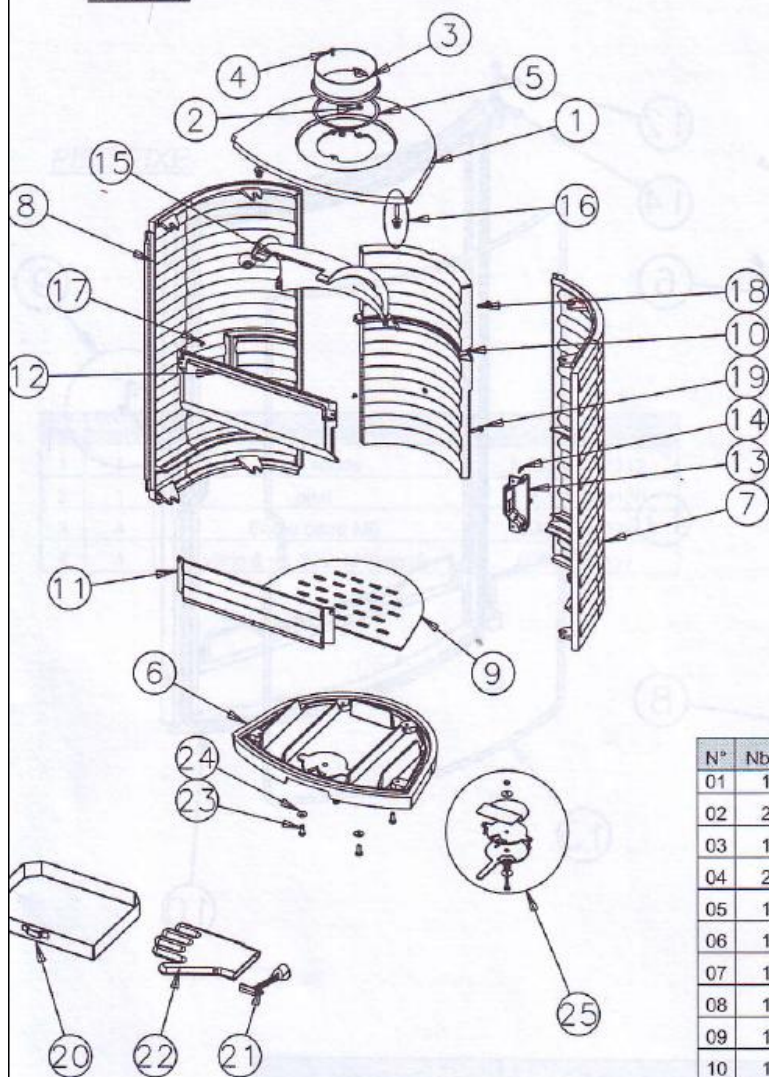

N°	Nbre	Désignation	Codification
01	1	Dessus	1 1101 389130
02	2	Ecrou carre brut M6	00001300270
03	1	Buse ronde Ø153	1 4312 5743 01
04	2	Vis TRL M5X16 pozie ZN noir	00001305477
05	1	Joint pyroseal lg410mm	00001308198
06	1	Fond	1 2205 389 130
07	1	Côté droit	1 2301 389130
08	1	Côté gauche	1 2305 389130
09	1	grille	1 0214 389130
10	1	boite conduit air	1 3906 389130
11	1	chenet	1 0306 389130
12	1	raccord de façade	1 2170 389130
13	1	cache	1 3239 389130
14	2	vis TF M5x16	00001305315
15	1	défecteur	1 0131 389130
16	4	Boulon M8x35	1 9201 398130 098
17	2	Vis TF M5X10	00001301185
18	4	Vis HC M6x25 BOUT PLAT	07VST0625
19	4	Ecrou à embrase crantée M6	07EE06
20	1	Cendrier	1 3316 389130
21	1	Clé à crochet	1 4101 3720 01
22	1	Gant bouclette T10	00001307770
23	4	Vis TH M8X20 ZN noir	00001301145
24	4	Rondelle JZC diamètre 8	00001300901
25	1	Volet réglage air	1 4137 389130 098

PORTE ET FACADE

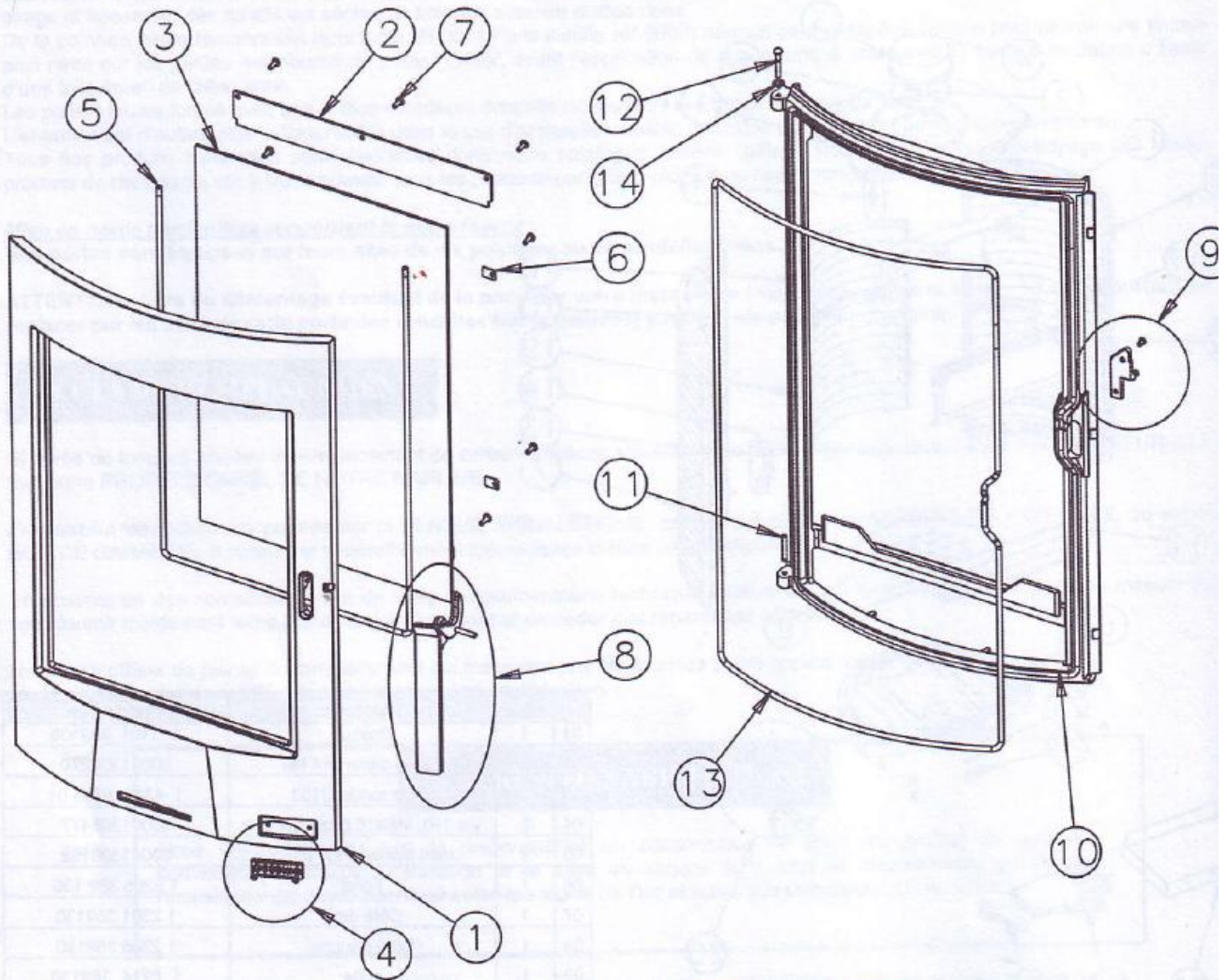

N°	Nbre	Désignation	Codification
01	1	Porte foyer	1 2861 389130
02	1	Conduit air	1 0317 389130
03	1	Verre réfractaire (603X390)	00001307478
04	1	Ensemble écusson	1 8501 389130 098
05	1	Tresse verre réfractaire dia 7mm - lg 1600mm	00001304690
06	6	Fixe vitre	1 2071 660101 018
07	9	Vis TRL M5X16 pozie ZN noir	00001305477
08	1	Ensemble poignée	1 5635 389130 098
09	1	Ensemble loquet de fermeture	1 048 389130 098
10	1	Façade	1 2101 389130
11	1	Goupille cannelée 6x40	00001305127
12	1	Rivet acier TR 6x40	00001305507
13	1	Tresse porte foyer dia: 7mm - lg:2500mm	00001304690
14	1	Ressort seul RS6 Starlock	00001307254

PIED FIXE

N°	Nbre	Désignation	Codification
1	1	Pied soude	1 2208 377117
2	1	piéd	1 2208 389130
3	4	Ecrou carre M6	00001300270
4	4	Verin à vis Ø30 M10xlg20	00001308197

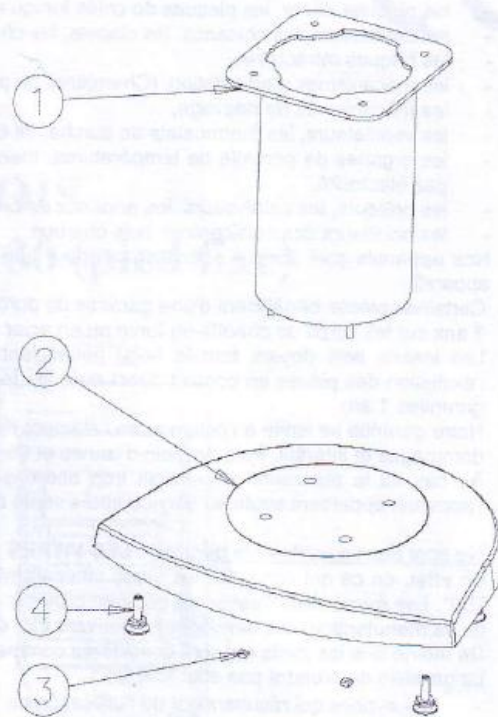

WARRANTY CONDITIONS

Any warranty is subject to: correct installation, use and maintenance of the unit.

All our appliances have a 2 year guarantee (except inserts running with wood – closed fireboxes running with wood) against any defect starting on the date of purchase. This guarantee is subject to the inspection of the installation, use and maintenance conditions described in the instruction manual supplied with the appliance.

Parts that are in direct contact with high temperatures and that could undergo distortions caused by wear and tear **are guaranteed for 1 year**. This includes:

1. Decorative panels, side panels, grills, front hearth floors, grates.
2. Guide plates, baffles, valves, ash pits, air channels and fire-bricks.
3. Articulation mechanisms (Door hinges and handles etc.)
4. Fans , thermostats for overheating of appliances equipped with blast engine
5. Temperature control elements, oven thermostats, and for fan heated gas/electric cookers
6. Burners, catalysers, burner rings for fuel appliances
7. Boilers for central heating and cooking systems for wood/coal.

Our appliances have been specially designed to facilitate replacing of these parts.

Some parts have a longer guarantee:

3 years for cast iron or steel heating body of our boilers for central heating.

Wood-burning Inserts and closed fireboxes running with wood, have a 5 year warranty (only the heating body, parts in direct contact with high temperatures and undergoing wear and tear, described above have 1 year guarantee.)

Only the parts/s that are deemed to have failed will be covered by the warranty. Any indemnity, compensatory damage, cost of labour and transportation is not included.

In cases the repair or replacement reveals to be too expensive compared to the price of the appliance, the decision to replace or to repair the appliance is to be taken by Godin after sales service only.

Parts not covered by warranty:

1. GLASS – ceramic glass can withstand temperatures of up to 750°C. The glass can only break because of a mechanical shock while using or handling the appliance.
2. Glass seals and ceramic rope seals are considered wear and tear items.

The following will invalidate any warranty:

1. Damage caused by burning fuels other than those for which the unit is intended.
2. Any defect or deterioration caused by a fall, shock, negligence or lack of supervision and maintenance.
3. Deterioration of parts caused by abnormal conditions (back draft, dampness, storm effects, pressure and depression of non conform, temperature shock etc).
4. Abnormal usage of the unit (using a unit with the door open, running it on maximum for extended periods) or abnormal usage of the appliance in conditions that are different from the conditions in our manual for which it has been designed, for example non observation of our technical manuals (wrong electric connection, running an empty boiler etc)
5. Any defect, deterioration or accident caused by fall, shock, negligence, lack of the buyer's supervision or maintenance.
6. Any modifications or transformations made to the unit and non-compliance with installation norms.

Godin SA will not be responsible for any installation, assembly, dismantling costs and consequential removal of the appliance.

Consequently Godin SA, cannot be held responsible for any materials loss or human accidents, being a result of incorrect installation non – observing the legal provisions and regulations (for example, lack of ground connection, incorrect draft of the chimney etc...)

In order to constantly improve our products, we reserve the right to modify our appliances without prior notice. All the dimensions and specifications give are subject to variation according to technical requirements.

In case of a problem occurred during your guarantee period, please contact your retailer providing him with a copy of your bill and guarantee containing the appliances product codes, the retailers stamp, the date of the appliance installation.